

Enardo 660 and Enardo 660-L

Thief Hatch

D104121X016

Introduction

Enardo™ 660 spring-loaded thief hatches are designed with a round base and cover. It is intended for use on steel and fiberglass tanks which require a tighter seal for reduced vapor loss.

Enardo 660-L is a spring-loaded thief hatch designed with a long basin and cover. The long basin serves as a thief shelf. The design also includes an inclining base to keep the basin level.

Model Numbers

Enardo 660 and Enardo 660-L

Bolt Pattern

8 in. API

Valve Setting Range

Pressure: 2, 4, 6, 8, 12, 16, 24 and 32 oz./sq. in.

Vacuum: 0.4, 0.9 and 3.5 oz./sq. in.

Construction Materials

Construction

Aluminum castings (non-sparking)

Optional Equipment

Plastic Trim (PT), Base Gasket, Bolt Set, Non-Corrosive Coating

Approximate Shipping Weight

Enardo 660: 25 lbs

Enardo 660-L: 45 lbs

Additional Technical Data

For more technical information, contact your local Sales Office or log on to:

www.enardo.com



Figure 1. Enardo 660



Figure 2. Enardo 660-L

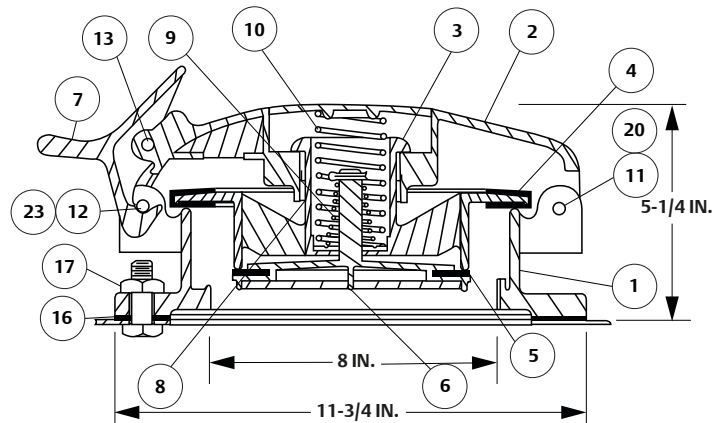

Figure 3. Enardo 660 Assembly Drawing

Table 1. Enardo 660

KEY	PART NUMBER	PART NAME	MATERIAL	QUANTITY
1	61A	Base	Cast Aluminum	1
2	63	Cover	Cast Aluminum	1
3	72SA	Center (see Center Assembly)	Assembly	1
3 ⁽¹⁾	72SA1-PT	Center (see Center Assembly)	Plastic Assembly	1
4	70-H	Envelope Pressure Gasket	Nitrile (NBR)	1
4 ⁽¹⁾	70-HV	Envelope Pressure Gasket	Viton®	1
5	74-G	Vacuum Gasket	Buna-N	1
5 ⁽¹⁾	74-GV-SP	Vacuum Gasket	Viton® Sponge	1
6	64-F	Vacuum Disk	Cast Aluminum	1
7	9	Latch	Cast Aluminum	1
8	72	Center	Cast Aluminum	1
9	660-VS-1/2	Vacuum Spring	Plated	1
9 ⁽¹⁾	660-VS-1/2I	Vacuum Spring	Inconel®	1
10	660-PS-4	Pressure Spring	Plated	1
10 ⁽¹⁾	660-PS-4I	Pressure Spring	Inconel®	1
11	4505112	Hinge Clevis Pin	CRS Plated	1
12	4505110	Latching Clevis Pin	CRS Plated	1
13	5-C	Latch Pin	CRS Plated	1
16 ⁽²⁾	660-BG	Base Gasket	Tank Packing	1
17 ⁽²⁾	1/2 - 13 x 1 - 1/2	Hex Bolt	Plated	16
17 ⁽²⁾	1/2-13	Hex Nut	Plated	16
19	HCP-148	Hinge Pin Clip	Plated	6
20	2000703	Hinge/Latching Cotter Pin	Plated	2

1. Plastic trim series furnished upon request only - for sour gas.

2. Furnished upon request only.



Enardo 660 and Enardo 660-L

Thief Hatch

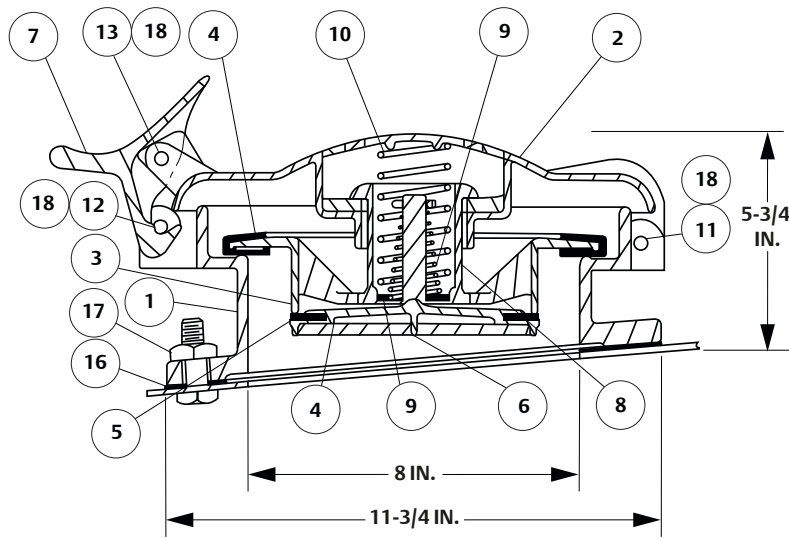

Figure 4. Enardo™ 660-L Assembly Drawing

Table 2. Enardo 660-L

KEY	PART NUMBER	PART NAME	MATERIAL	QUANTITY
1	61LC	Base	Cast Aluminum	1
2	63L	Cover	Cast Aluminum	1
3	72SA1	Center (see Center Assembly)	Assembly	1
3 ⁽¹⁾	72SA1-PT	Center (see Center Assembly)	Plastic Assembly	1
4	70-H	Envelope Pressure Gasket	Nitrile (NBR)	1
4 ⁽¹⁾	70-HV	Envelope Pressure Gasket	Viton®	1
5	74-G	Vacuum Gasket	Buna-N	1
5 ⁽¹⁾	74-GV-SP	Vacuum Gasket	Viton® Sponge	1
6	64-F	Vacuum Disk	Cast Aluminum	1
7	9	Latch	Cast Aluminum	1
8	72	Center	Cast Aluminum	1
9	660-VS-1/2	Vacuum Spring	Plated	1
9 ⁽¹⁾	660-VS-1/2I	Vacuum Spring	Inconel®	1
10	660-PS-4	Pressure Spring	Plated	1
10 ⁽¹⁾	660-PS-4I	Pressure Spring	Inconel®	1
11	5	Cover Hinge Pin	CRS Plated	1
12	5-N	Latching Pin	CRS Plated	1
13	5-C	Latch Pin	CRS Plated	1
16 ⁽²⁾	660-BG	Base Gasket	Tank Packing	1
17 ⁽²⁾	1/2 - 13 x 1 - 1/2	Hex Bolt	Plated	16
17 ⁽²⁾	1/2-13	Hex Nut	Plated	16
18	HCP-148	Hinge Pin Clip	Plated	6

1. Plastic trim series furnished upon request only - for sour gas.
2. Furnished upon request only.

Inconel® is a mark owned by Special Metals Corporation.
Viton® is a mark owned by E. I. du Pont de Nemours and Company.