

NOTE :  
SEE GENERAL ARRANGEMENT DRAWING FOR ACTUAL  
LOCATIONS OF BUILDING EQUIPMENT.

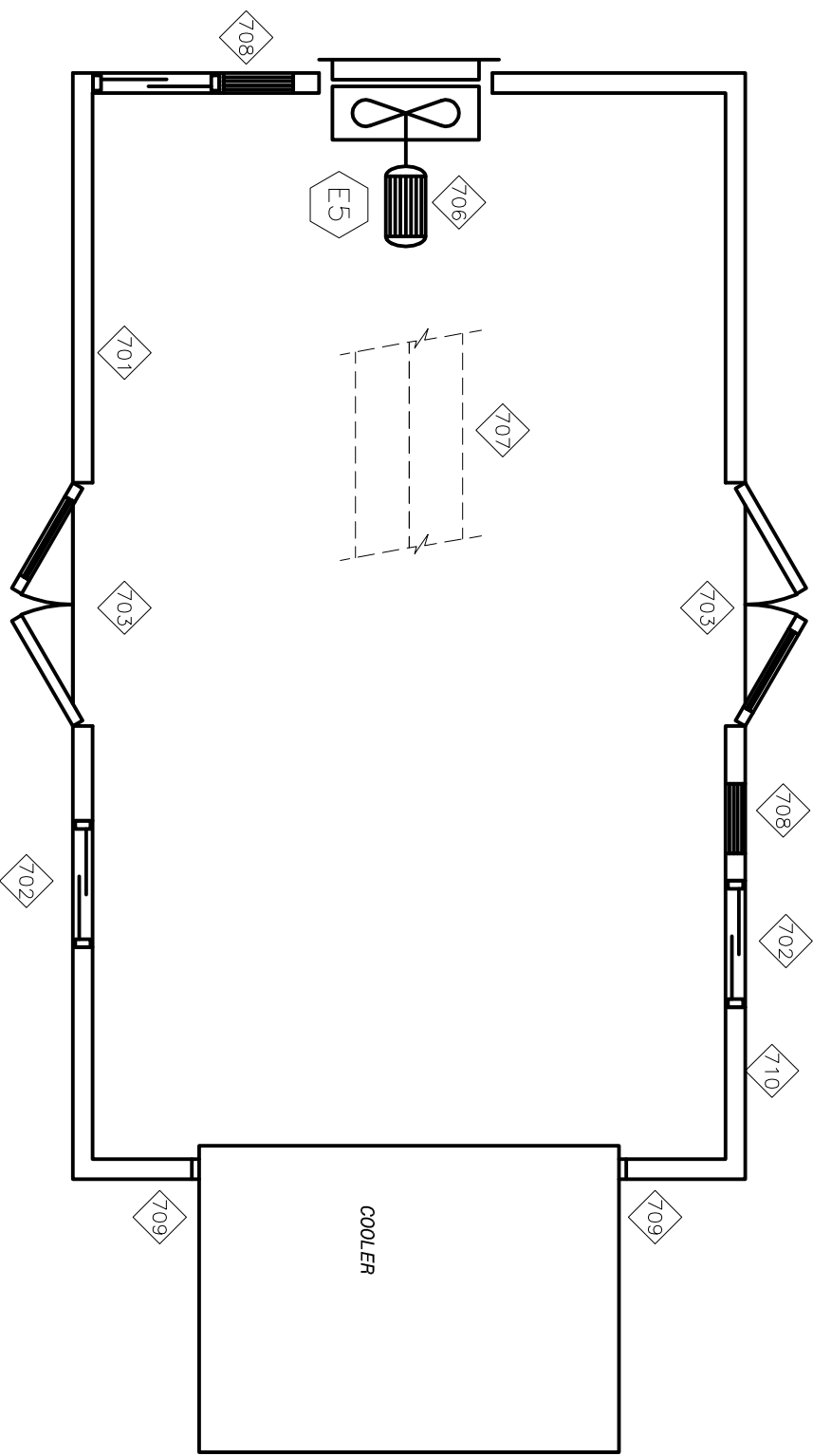

## BILL OF MATERIAL

ITEM QTY.	CODE No.	DESCRIPTION
701	1	AXB-2PR4PPA BLDG: 22 G PREPAINTED ST, 24 G PREPAINTED ALUM, R12 BATT INS
702	2	EBF-WGI DOUBLE GLAZED, 40" X 40" IMG WINDOW
703	2	EBF-DD DBL MANDOODOR 6' X 7'ST IMG WINDOW CLOSER PAN HARDWARE
706	1	EBF-1WR12 EXH FAN, WALL MTD, 120V/60HZ/1 XP CSA
707	16	EBF-R06 LIN FT RIDGE VENT, 6" THROAT C/W MAN DAMP AND BIRD SCREEN
708	2	EBF-ML3030 LQVRE, MANUAL ADJUSTABLE 18" X 30" WITH BIRD SCREEN
709	1	EBF-FL FLASHING AROUND COOLER AS REQUIRED
710	1	EBF-VB VAPOUR BARRIER, WALLS AND ROOF AREA OF 4 MIL GENERAL PURPOSE POLYETHYLENE
711	1	EBF-PENG PROF. ENGINEER STAMP ON BUILDING DRAWING

### COLOR SCHEDULE

WALL INTERIOR LINER : PRE-PAINTED ALUMINUM: WHITE  
WALL EXTERIOR LINER : SURF WHITE  
ROOF INTERIOR LINER : PRE-PAINTED ALUMINUM: WHITE  
ROOF EXTERIOR LINER : SURF WHITE  
TRIM : CRESTAR GREEN  
COOLER : WARM GRAY  
EQUIPMENT : WARM GRAY  
SKID & VESSEL SKIRTS : WARM GRAY  
GRATING : BLACK (STANDARD)

NOTE: TWO (2) COATES OF FINISH PAINT REQ'D.

### DIMENSIONS

WIDTH : 14 Ft.  
LENGTH : 18 Ft.  
EAVE HEIGHT : 9 Ft.  
ROOF SLOPE : 3 : 1

### BUILDING EQUIPMENT AND DETAILS

MAKE NO REVISIONS  
TO THIS REPRODUCIBLE

**CAD**

FILENAME: -- .DWG	ISSUE#: 0	CUSTOMER: CRESTAR ENERGY INC. LITTLE BOW, ALBERTA	JOB No.: 96044	AS BUILT	T. T.	96-08-14	ORIG DWN BY: DLL	TITLE: SCHEMATIC BUILDING EQUIPMENT AND CONTROLS
LAST DRAWING SAVE DATE:				RE-ISSUE FOR CONSTRUCTION	T. T.	96-06-27	DATE:	DWG:
				ISSUE FOR CONSTRUCTION	DW	96-06-17	APPR'D BY:	SF96044G
				FOR APPROVAL	By		DATE:	OPBR'N#:
				Description				70



ENERFLEX SYSTEMS LTD.